

**NEW
PRODUCT!**

**ISO Turning Insert with 11° (P) clearance angle
Lower cutting force, better surface quality and longer tool life**

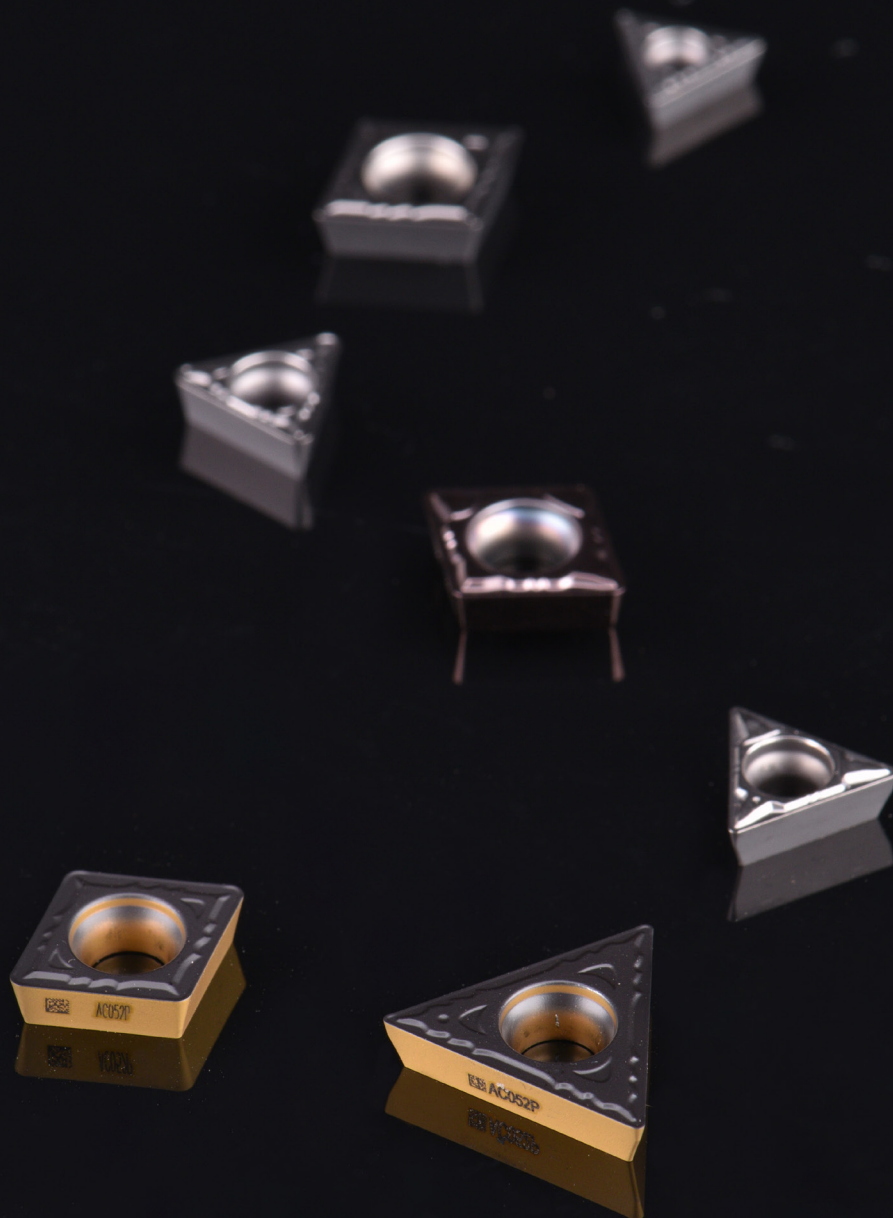

ISO Turning Positive 11° (P) clearance angle series

Suitable for various cutting conditions!

Geometry

1st Choice for
Steel Finishing

PB1

1st Choice for
Steel Semi-Finishing

PC2

Positive rake angle can reduce adhesion tendency, ensure good surface quality and longer tool life. Suitable for steel and stainless steel turning.

Edge inclination angle is good for light cutting; Sharp cutting edge avoids BUE effectively; Better chip evacuation.

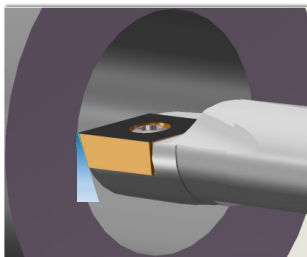
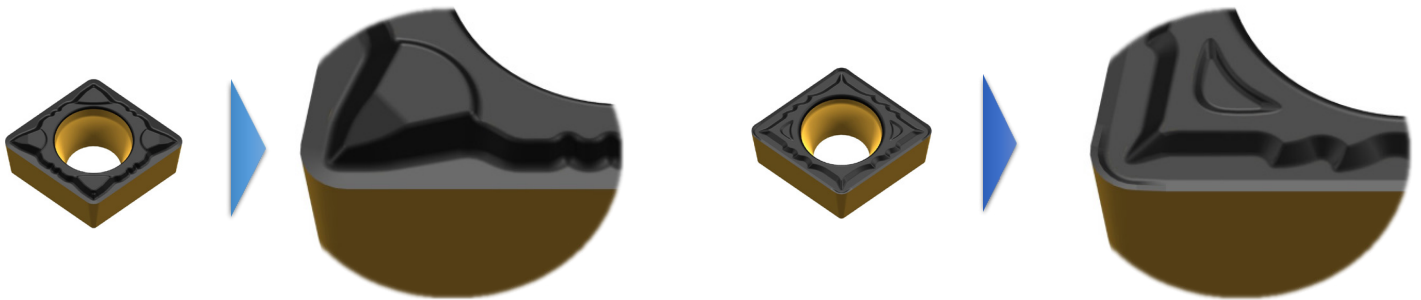

7°(C) clearance angle with narrow space

Bigger clearance angle

11°(P) clearance angle, bigger space for more applications

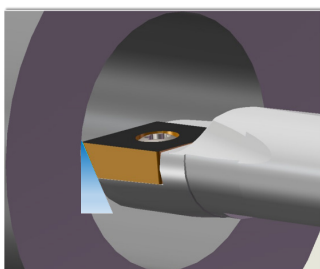

11°(P) clearance angle with bigger space

Lower cutting force

11°(P) clearance angle, lower cutting force and wider applications

11° (P) clearance angle insert list

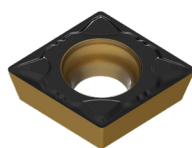
Insert	Product code	Dimension (mm)				Recommended parameters		Grade	
		RE	IC	S	D1	f (mm/rev)	ap (mm)	AC052P	AT202
	CPMT 080202E-PB1	0.2	7.94	3.40	2.38	0.02-0.07	0.15-2.00	●	●
	CPMT 080204E-PB1	0.4	7.94	3.40	2.38	0.04-0.14	0.30-2.00	●	●
	CPMT 090302E-PB1	0.2	9.525	4.40	3.18	0.02-0.07	0.15-2.40	●	●
	CPMT 090304E-PB1	0.4	9.525	4.40	3.18	0.04-0.14	0.30-2.40	●	●
	CPMT 090308E-PB1	0.8	9.525	4.40	3.18	0.09-0.28	0.60-2.40	●	●
	CPMT 090304E-PC2	0.4	9.525	4.40	3.18	0.05-0.16	0.35-2.90	●	●
	CPMT 090308E-PC2	0.8	9.525	4.40	3.18	0.15-0.32	0.70-2.90	●	●
	TPMT 090202E-PB1	0.2	5.56	2.50	2.38	0.02-0.07	0.15-1.90	●	●
	TPMT 090204E-PB1	0.4	5.56	2.50	2.38	0.04-0.14	0.30-1.90	●	●
	TPMT 090208E-PB1	0.8	5.56	2.50	2.38	0.09-0.28	0.60-1.90	●	●
	TPMT 110302E-PB1	0.2	6.35	3.40	3.18	0.02-0.07	0.15-2.20	●	●
	TPMT 110304E-PB1	0.4	6.35	3.40	3.18	0.04-0.14	0.30-2.20	●	●
	TPMT 110308E-PB1	0.8	6.35	3.40	3.18	0.09-0.28	0.60-2.20	●	●
	TPMT 160304E-PB1	0.4	9.525	4.40	3.18	0.04-0.14	0.30-3.30	●	●
	TPMT 160308E-PB1	0.8	9.525	4.40	3.18	0.09-0.28	0.60-3.30	●	●
	TPMT 090204E-PC2	0.4	5.54	2.50	2.38	0.05-0.16	0.35-2.60	●	●
	TPMT 090208E-PC2	0.8	5.536	2.50	2.38	0.10-0.32	0.70-2.60	●	●
	TPMT 110304E-PC2	0.4	6.328	3.40	3.18	0.05-0.16	0.35-3.00	●	●
	TPMT 110308E-PC2	0.8	6.35	3.40	3.18	0.10-0.32	0.70-3.00	●	●

● Stocked